

Under the web-address <https://www.process-informatik.de> are product specific documentations or software-driver/-tools available to download.
If you have questions or suggestions about the product, please don't hesitate to contact us.

Process-Informatik Entwicklungsgesellschaft mbH
Im Gewerbegebiet 1
DE-73116 Wäschenbeuren
+49 (0) 7172-92666-0
info@process-informatik.de
<https://www.process-informatik.de>

Menutree Website:

- + Products / docu / downloads
- + Accessories
- + Connector / Power supply
- + AC adapter



QR-Code Website:



Please make sure to update your drivers before using our products.

Management of the IP address

-IP-Zugriffsschutz

Schutzmodus:

IP-Adresse / IP-Bereich #1:	192.168.178.10	- Bereich (optional)
IP-Adresse / IP-Bereich #2:	192.168.178.100	- 192.168.178.200
IP-Adresse / IP-Bereich #3:	192.168.178.254	- Bereich (optional)
IP-Adresse / IP-Bereich #4:		- Bereich (optional)
IP-Adresse / IP-Bereich #5:		- Bereich (optional)
IP-Adresse / IP-Bereich #6:		- Bereich (optional)
IP-Adresse / IP-Bereich #7:		- Bereich (optional)
IP-Adresse / IP-Bereich #8:		- Bereich (optional)
IP-Adresse / IP-Bereich #9:		- Bereich (optional)
IP-Adresse / IP-Bereich #10:		- Bereich (optional)
IP-Adresse / IP-Bereich #11:		- Bereich (optional)
IP-Adresse / IP-Bereich #12:		- Bereich (optional)
IP-Adresse / IP-Bereich #13:		- Bereich (optional)
IP-Adresse / IP-Bereich #14:		- Bereich (optional)
IP-Adresse / IP-Bereich #15:		- Bereich (optional)

IPs aus Liste verbieten

The IP filter is used to determine whether or not the entered IP-addresses or IP-address-ranges may communicate with the connected controllers via the module.

The list can be edited centrally be switched with a button from "allowed" on "not allowed".

Worldwide remote-access thanks to our own cloud

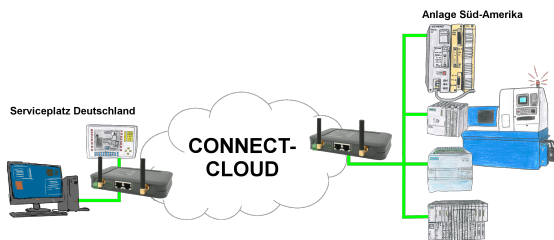

Worldwide remote-maintenance without additional costs thanks to our own cloud

Your devices connect to your own cloud, no matter where they are in the world. Only your devices are in your own private cloud, no one else has access to the cloud. In addition, you can provide each device with its own connection-password, so that the individual systems are protected despite the private cloud.

No registration on any portals, no hidden additional costs, your devices in your own cloud are always accessible.

This is how remote maintenance/remote access is fun.

Data backup S7-PLC over MPI/Profibus on USB-stick via dig. IO

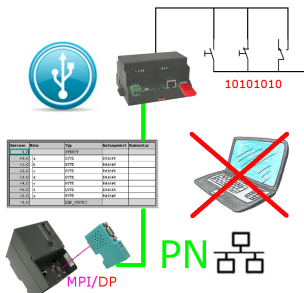

Via digital input triggered DB-backup/-restore without additional PC via MPI/Profibus to USB-stick

Battery buffered time

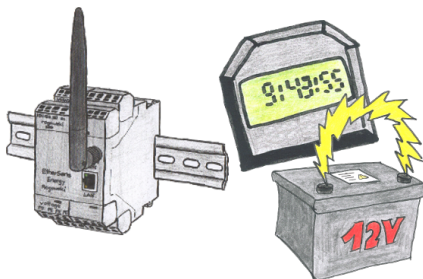

You always need a current time, but do not always have a time-server on site. With the integrated battery-backed RTC you always have the current time in the unit. Even if the power fails, the time in the unit continues to operate, so that when the voltage returns, the time continues to run correctly.

Serial communication with CP and more S5-assemblies

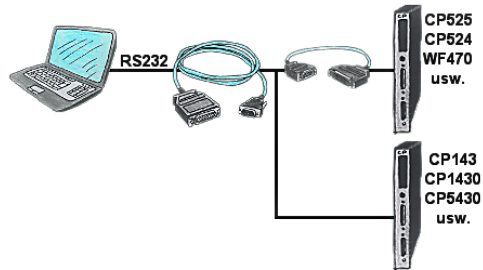

You have a PC with programming software and a 9pin COM-port as interface? No problem, for this purpose the PG-UNI-cable is exactly the right product. Connect it to a Siemens assembly such as H1-CP (CP1430), WF470 and PC or CP-525 with the CP525-adapter and PC and you're Online.

Direct Fax

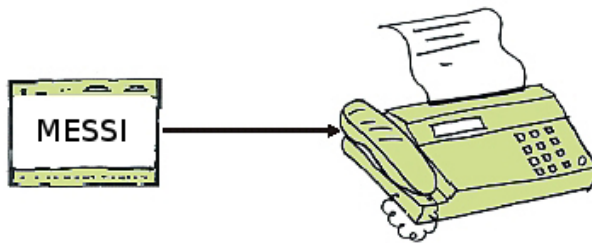

By direct dialling up the fax machine a message is carried out to a fax-receiver. If a connection comes off the message will be transmitted.