

Under the web-address <https://www.process-informatik.de> are product specific documentations or software-driver/-tools available to download.
If you have questions or suggestions about the product, please don't hesitate to contact us.

Process-Informatik Entwicklungsgesellschaft mbH
Im Gewerbegebiet 1
DE-73116 Wäschenbeuren
+49 (0) 7172-92666-0
info@process-informatik.de
<https://www.process-informatik.de>

Menutree Website:

- + Products / docu / downloads
- + Hardware
 - + Programming devices
 - + Other interface cables



QR-Code Website:



Please make sure to update your drivers before using our products.

Data backup S7-PLC over MPI/Profibus on SD-card

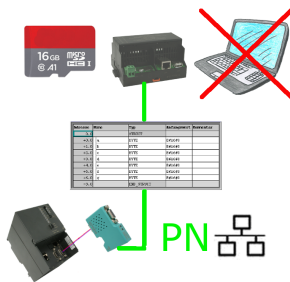

S7-PLC triggered DB-backup/-restore without additional PC via MPI/Profibus on SD-card

S5-PLC-diagnosis or signal's doesn't come, but why?

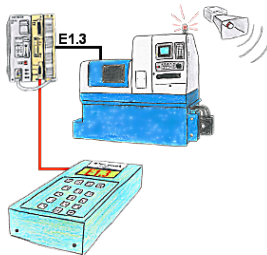

Your installation shows an error and the commissioning engineer isn't available?

Connect S5-DIAG with the PLC, enter reason of PLC's malfunction (e.g. O32.5 doesn't come) and the device lists all possibilities why the output has not been set.

So you're able to figure out the problem (e.g. safety door not locked) quickly.

Finding the cause of the malfunction can be so quick and easy.

Extend MPI/DP-bus over network or convert to network

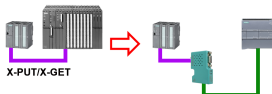
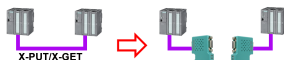

MPI/DP communication between two S7-300/400 controllers on the same bus

- a control is relocated spatially:

2x S7-LAN with activated X_PUT/X_GET module, the data is transported between the modules via the network.

- a control is replaced by a PN control:

1x S7-LAN with activated X_PUT/X_GET module and the received-data are transferred automatically to the configured PN-PLC via PUT/GET.

Easy Web-Visualization



You need a web-visualization which is kept simple, with no additional Plugins like ActiveX, Flash(R) or Java(R) and is compatible with most general browser? Then you have found with S7-Visu the solution. Visualizations under Windows(R)/Linux on PC-based systems are just realizable as those for tablets or Phones with browser support. The simultaneous operation of multiple browsers at the same time is possible.

Backup of formulas without knowledge of PLC

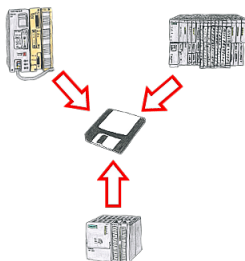

You consistently have to back up formulas which are stored in data blocks or back up production protocols, but the employee in charge has no knowledge of PLC-programming respectively handling PC-programs? No problem, install the PG-2000-software with "option DB-backup" on your PC and connect it with the PLC. The employee only has to click on a symbol on the desktop of the PC and the data blocks of the parameterised PLC will be stored on the fixed disc. Afterwards the program closes itself and the mentioned employee didn't had to accomplish an intervention on the program.

Wireless around the Pilz-PLC



Move wirelessly around the Pilz-PLC and communicate for example ONLINE in the status