

## Step5/7-Programming system PG-2000

### Installation note:

Load your license file using the link given in your personal license email.  
The password for extraction can also be found in this email. Then copy this file into the folder of the installed PG-2000 software (demo version).  
After restarting the software, your license is active.

Under the web-address <https://www.process-informatik.de> are product specific documentations or software-driver/-tools available to download.  
If you have questions or suggestions about the product, please don't hesitate to contact us.

Process-Informatik Entwicklungsgesellschaft mbH  
Im Gewerbegebiet 1  
DE-73116 Wäschenbeuren  
+49 (0) 7172-92666-0  
[info@process-informatik.de](mailto:info@process-informatik.de)  
<https://www.process-informatik.de>

### Menutree Website:

- + Products / docu / downloads
- + Software
  - + Programming-software PG-2000 Step5 & Step7
  - + Basic packages AWL

### QR-Code Website:



```

NETWORK 1  LOG 2 ALLUHI111PROGRAMM
[EN]  C:\PROGRAMM\PG2000
[DE]  H 2000.5
[FR]  H 2000.5
[IT]  H 2000.5
[ES]  H 2000.5
[PT]  H 2000.5
[RU]  H 2000.5
[UK]  H 2000.5
[US]  H 2000.5
[JP]  H 2000.5
[CN]  H 2000.5
[IN]  H 2000.5
[BR]  H 2000.5
[AR]  H 2000.5
[CL]  H 2000.5
[CO]  H 2000.5
[CR]  H 2000.5
[CY]  H 2000.5
[DK]  H 2000.5
[EE]  H 2000.5
[FI]  H 2000.5
[FR]  H 2000.5
[GR]  H 2000.5
[GT]  H 2000.5
[HK]  H 2000.5
[HU]  H 2000.5
[IL]  H 2000.5
[IS]  H 2000.5
[IT]  H 2000.5
[JP]  H 2000.5
[KR]  H 2000.5
[LV]  H 2000.5
[LT]  H 2000.5
[LU]  H 2000.5
[MT]  H 2000.5
[MX]  H 2000.5
[MY]  H 2000.5
[NI]  H 2000.5
[NL]  H 2000.5
[NO]  H 2000.5
[NZ]  H 2000.5
[OM]  H 2000.5
[PA]  H 2000.5
[PE]  H 2000.5
[PH]  H 2000.5
[PL]  H 2000.5
[PT]  H 2000.5
[RO]  H 2000.5
[RS]  H 2000.5
[RU]  H 2000.5
[SE]  H 2000.5
[SI]  H 2000.5
[SK]  H 2000.5
[SN]  H 2000.5
[SV]  H 2000.5
[TH]  H 2000.5
[TR]  H 2000.5
[UA]  H 2000.5
[UG]  H 2000.5
[US]  H 2000.5
[VE]  H 2000.5
[VI]  H 2000.5
[VN]  H 2000.5
[WA]  H 2000.5
[YE]  H 2000.5
[ZA]  H 2000.5
[ZW]  H 2000.5

```

Please make sure to update your drivers before using our products.

## Data backup S5-PLC on USB-stick

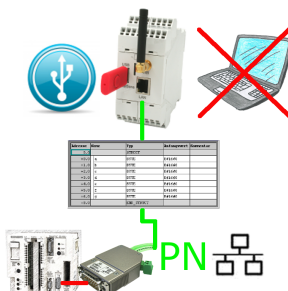

S5-PLC triggered DB-backup/-restore without additional PC via PG-socket and Ethernet on USB-stick

## Extension of a 3964R-line via LAN

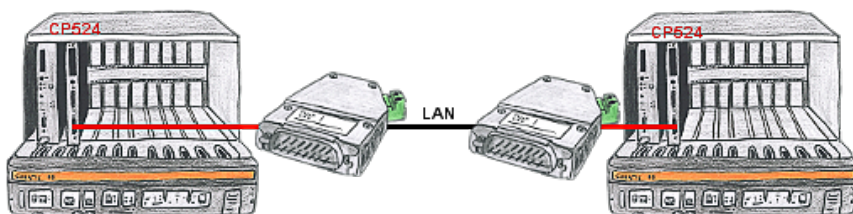

There is a control with CP524 in your outstation and the communication partner of the CP has moved locally. Connecting path is a LAN-network. So each of both participants gets a 3964R-LAN and after input of the partner's IP-address a coupling via LAN will be configured.

## Without LAN-cable round of the PLC

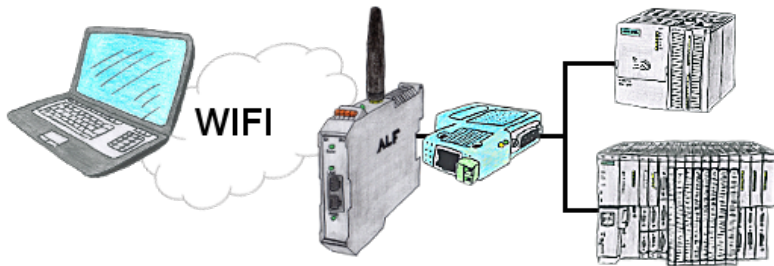

You're right in the middle of your production line and should move around the machine and simultaneously observe / manage. No problem, you parameterize the ALF, connect to the S7-LAN and connect to the WIFI-network of the ALF and are ONLINE on the PLC.

## Coupling of S5-PLC with S7-PLC via PD-interfaces

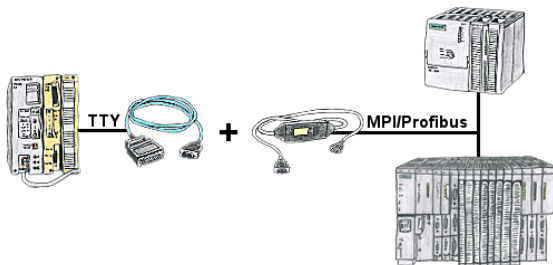

S5 in the machine-park, conversion to S7 not profitable, central-control still requires production-data, who does not know this problem.

With "S5anMPI" you connect the S5-PLC with a standard interface-cable with the MPI/PROFIBUS of a S7-PLC. Loading handling-blocks in both PLCs, communication integrated and "S5anMPI" exchanges DB-content on request of the respective PLC. Configuration in the "S5anMPI" which PLC is active, also both PLCs active is possible.

Data-exchange without much effort and the S5-PLC continues in the S7-combination as usual and does not have to be replaced.

## Profinet-Member-Analysis



Exact analysis of your Profinet members.

Addresses, configurations and other data can be recorded directly.

See immediately possible conflicts due to the configuration.

## Access to MPI/Profibus without power supply

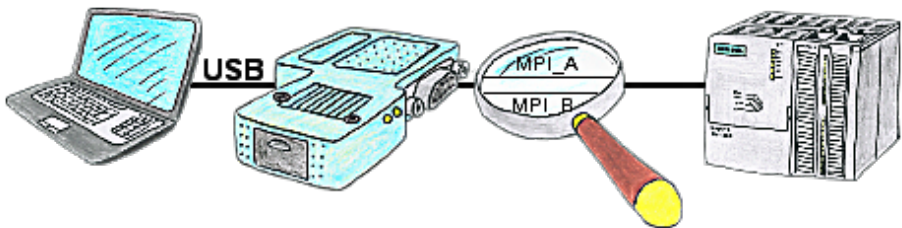

You're right in the middle of your production line and are standing in front of a passive assembly just like a switcher or a ET200, in that case you won't be able to go Online without an external power supply of your programming adapter, unless you're using the S7USB. This module is supplied completely from the USB-interface.